

INSTALLATION

Preparations



Note

For details on sounds emissions, see chapter "Specification / Data table".

9.4 Siting the appliance

- ▶ Carefully undo the cardboard packaging at the clips.

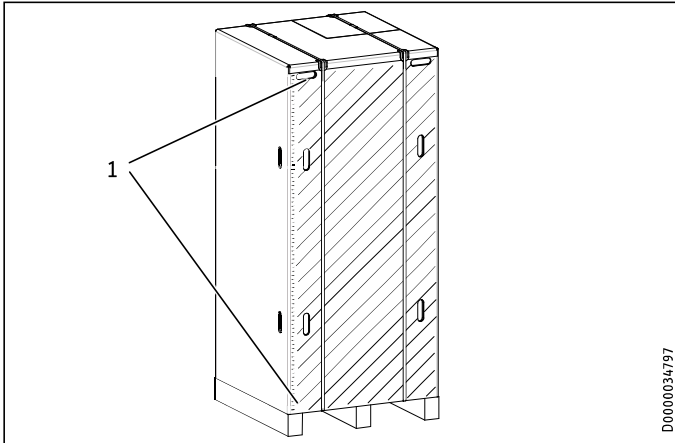

D0000034797

1 Cardboard packaging clips

The appliance is secured to the pallet with metal brackets and screws. The metal brackets are hooked on to the feet underneath the floor plate of the appliance.

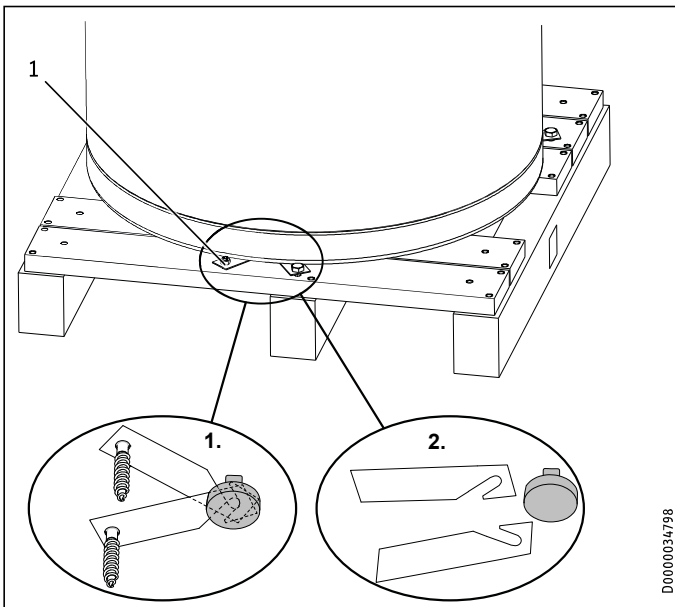

D0000034798

1 Metal bracket fixing screw

- ▶ Remove the fixing screws of the metal brackets from the pallet.
- ▶ Push the metal brackets a little towards the cylinder centre to unhook them from the appliance feet.
- ▶ Pull the metal brackets out from underneath the appliance.



Material losses

Take note of the appliance's weight and centre of gravity.

- ▶ Slightly tip the appliance and carefully roll the appliance off the pallet.
- ▶ Position the appliance in the final installation site.



Material losses

The appliance must be positioned vertically to avoid damage.

The feet under the floor plate of the appliance are height-adjustable.

- ▶ Level the appliance horizontally using the height-adjustable feet.

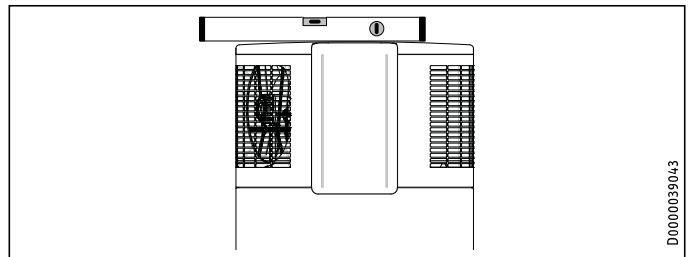

D0000039043

9.4.1 Minimum clearances

- ▶ Maintain the minimum clearances.

Connecting with straight pipe adapters

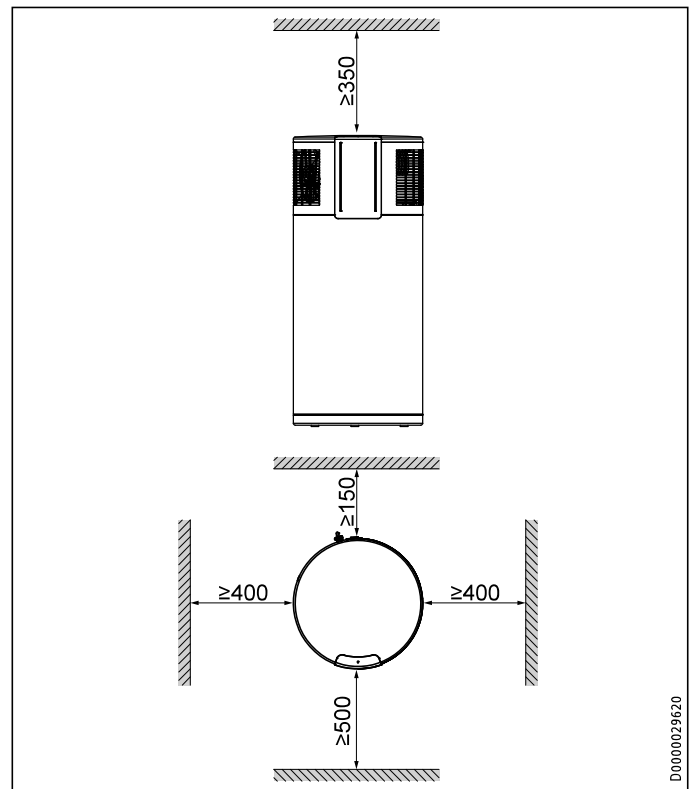

D0000029620



Note

If you install the supplied bracket pipe adapters on the "Cold water inlet" and "DHW outlet" connections, you can reduce the minimum clearance at the back of the appliance described in the following installation.

INSTALLATION

Installation

Connecting with bracket pipe adapters (mainly in Australia)

With these options, the "Cold water inlet" and "DHW outlet" connections are located on the right hand side or on the left behind the appliance.

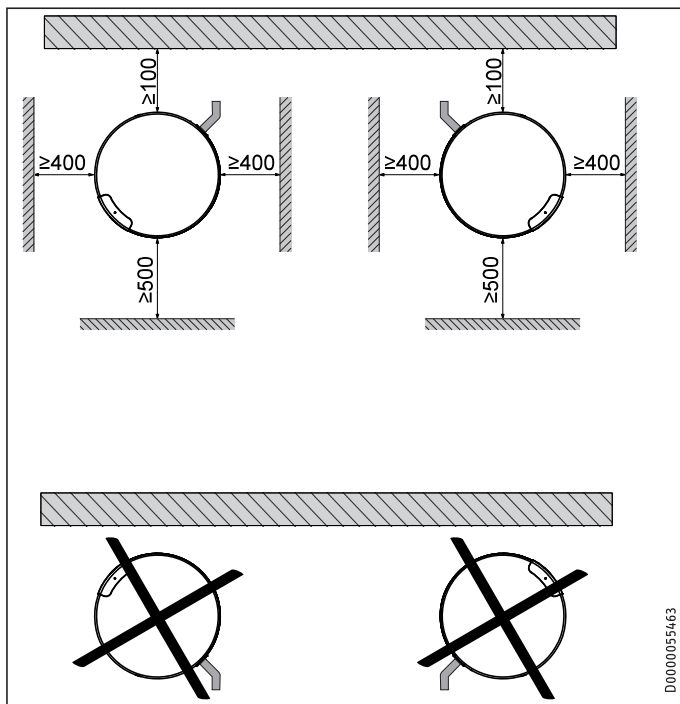

10. Installation



WARNING Injury
 Incorrect installation can lead to serious injury or material losses.
 Before any work, ensure sufficient clearances for the installation.
 Handle sharp-edged components carefully.

10.1 Water connection



Material losses
 Carry out all water connection and installation work in accordance with regulations.



Material losses
 The cathodic corrosion protection can only be guaranteed when the electrical conductivity of the domestic hot water is within the limits stated in the chapter "Specification / Data table".

The following material combinations are approved for metal pipework installations:

Cold water inlet	DHW outlet
Copper pipe	Copper pipe
Steel pipe	Steel pipe or copper pipe

- ▶ Thoroughly flush the pipework before connecting the appliance. Foreign bodies, such as plastic and metal shavings, rust, sand or sealant can impair the operational reliability of the appliance.



Material losses
 To protect the connections against corrosion the water connection must be made with flat gaskets. The use of hemp on connections is not permissible.

- ▶ Install the DHW outlet line and the cold water inlet line (see chapter "Specification / Dimensions and connections").

10.1.1 Safety equipment

A T&P valve or a safety valve (cold water expansion control valve) has to be installed. Observe all applicable national and regional regulations and instructions.

T&P valve (700 kPa)

- ▶ If specified, install a type-tested T&P valve using the corresponding connection on the appliance.

The response pressure of the valve must be below or equal to the permissible operating pressure of the DHW cylinder. The valve protects the appliance against unacceptable pressure or temperature rises. The diameter of the cold water supply line must be no greater than the diameter of the valve.

- ▶ Ensure that the expansion water escaping from the valve can drip into a drain, e.g. a tundish.

Ensure the drain cannot be shut off.

- ▶ Size the drain so that water can drain off unimpeded when the safety valve is fully opened.
- ▶ Ensure that the discharge pipe of the safety valve is open to atmosphere.
- ▶ Fit the discharge pipe of the safety valve with a constant downward slope and in a location free from the risk of frost.